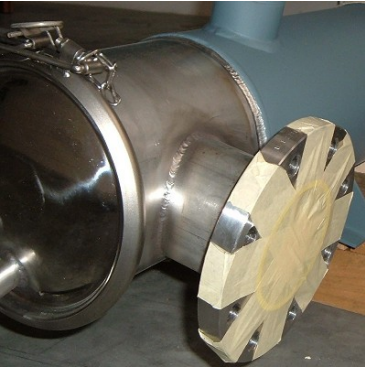

# T ST EXH

Engine exhaust / water

**Main technical features:**

Shell and tube heat exchangers of T ST EXH range are designed to allow maximum energy recovery from smokes of combustion, such as from engines and turbines.

This shell and tube is manufactured with straight tubes welded to end tube-sheets. Headers and smoke chambers are removable to allow an easy inside cleaning. Shell is completed with a thermal expansion joint. Adopted materials are of very high quality, according to European Regulations for pressure vessels:

- headers, tube-sheets, smoke inlets and thermal expansion joint in AISI 304 or AISI 316,
- shell and water inlets in carbon steel,
- tube heat exchangers in AISI 316,
- baffles in compatible materials with adopted fluids,
- asbestos free gaskets,
- high strength steel bolts,
- PED approval where requested, other approvals on request.

**Modifications:**

We keep the right to make, at any time and without prior notice, all modifications we think suitable and better to improve our products.

# T ST EXH

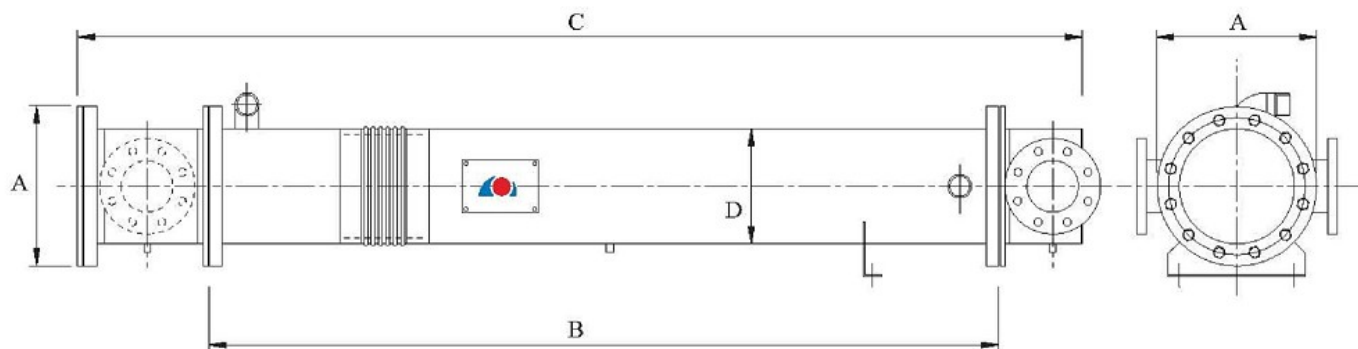

Model		FA. 273.1.2000.	FA. 323.1.2000.	FA. 406.1.2000.	FA. 508.1.2000.	FA. 610.1.2000.	
Capacity	(kW)	66	100	168	266	424	
Flowrate Gas	(kg/h)	592	905	1519	2402	3823	
DP Gas	(Pa)	975	968	950	1068	1077	
Flowrate H <sub>2</sub> O	(m <sup>3</sup> /h)	12	18	30	47	75	
DP H <sub>2</sub> O	(kPa)	8	9	16	17	15	
Dimension	A	(mm)	343	394	476	578	680
	B	(mm)	2000	2000	2000	2000	2000
	C	(mm)	2546	2648	2812	3016	3220
	D	(mm)	273	324	406	508	610
Connection Gas	(mm)	DN 150	DN 200	DN 300	DN 300	DN 400	
Connection H <sub>2</sub> O		2"	2 1/2"	3"	4"	DN 150	
Weight	(kg)	342	505	860	1360	2064	

Potenza indicata dello scambiatore alle condizioni di esercizio: acqua 85°C/90°C, fumi 500°C/120°C

Exchangers capacity at conditions: water 85°C/90°C, smoke 500°C/120°C

Leistungen beziehen sich auf folgenden Daten: Wasser 85°C/90°C, Rauchgas 500°C/120°C

Dati soggetti a possibili modifiche / Data subject to possible changes / Änderungen vorbehalten